

TOTAL EXTENT (AS PER PATTA) : 37210 SQ.M
ROAD AREA : 11114 SQ.M
PARK AREA (OSR) : 2763 SQ.M
PUBLIC PURPOSE PLOTS (I TO III) : 2626 SQ.M
TOTAL NO. OF PLOTS : 176 Nos.
REGULAR PLOTS (1 TO 133) : 133 Nos.
EWS PLOTS (134 TO 176) (2625 SQ.M) : 43 Nos.
SHOP SITE : 1 No.

NOTE:

- SPLAY - 3.0M x 3.0M, 1.5M x 1.5M
- MEASUREMENTS ARE INDICATED EXCLUDING SPLAY DIMENSIONS
- ROAD AREA } WERE HANDED OVER TO THE LOCAL BODY VIDE GIFT DEED
 PARK AREA } DOC.NO:1430/2018, DATED: 06.02.2018, SRO @ AVADI

CONDITIONS:

- THE FOLLOWING CONDITIONS OF PWD VIDE THE CE, WRD, CHENNAI REGION, CHEPAUK, CHENNAI-5, LETTER NO DB/75(3)/F-1&C-VILINJIAMBakkam/2018/13.06.2017, ARE TO BE COMPLIED BY THE APPLICANT BEFORE SANCTION OF THE LAYOUT.
- THE PROPOSED RCC BOX CULVERT - 3 NOS OF SIZE MENTIONED ABOVE ACROSS THE CHANNEL IN S.F.NO.52 OR 637A, SO AS TO ACCESS THE SITE S.F.NO.50 OR 625P TO S.F.NO.53 OR 638P - CULVERT NO-1, @ S.F.NO.46 OR 715, SO AS TO ACCESS THE SITE S.F.NO.48 OR 75 TO S.F.NO.53 OR 638 - CULVERT NO-2 AND @ S.F.NO.46 OR 715, SO AS TO ACCESS THE SITE S.F.NO.48 OR 75 TO S.F.NO.43 OR 811 - CULVERT NO - 3 WITHIN THE APPLICANTS LANDS AS EARMARKED IN THE SKETCH FOR TEMPORARY OCCUPATION FOR THREE YEARS FROM THE DATE OF AGREEMENT. THE WIDTH OF THE CHANNEL EARMARKED IN THE FMB SKETCH SHOULD BE MAINTAINED AS PER REVENUE RECORDS AND SHOULD BE MAINTAINED WITHOUT ENCROACHMENT. IF THE APPLICANTS LAND AVAILABLE ON BOTH SIDES OF THE CHANNEL THIS PERMISSION IS ELIGIBLE FOR CONSTRUCTION OF CULVERT. HOWEVER, IF THE CMDA INSISTS FOR ANY MORE CULVERTS DURING PLANNING APPROVAL, THE APPLICANT SHOULD APPROACH THE WRD FOR GETTING SEPARATE APPROVAL FOR ANY ADDITIONAL CULVERTS IN FUTURE.
- THE PROPOSED BOX CULVERT 3 NOS SHALL BE MADE UP OF RCC BOX TYPE WITH A MINIMUM VENT INNER SIZE, WIDTH AND HEIGHT FOR A CARRIAGE WIDTH OF 7.20M, 7.50M & 9.15M WELL WITHIN THE BOUNDARY. THE SIZE & SILL LEVEL OF THE PROPOSED RCC CULVERT SHOULD BE MAINTAINED AS MENTIONED BELOW IN THE SPECIFIED S.F. NO AND SHOULD BE GOT EXECUTED ONLY IN THE PRESENCE OF PWD/WRD OFFICIALS. THE BED LEVEL OF THE CULVERTS SHOULD BE FIXED IN PRESENCE OF THE EXECUTIVE ENGINEER CONCERNED. THE HYDRAULICS PARTICULARS OF PROPOSED CULVERT ARE AS FOLLOWS

B.M. F.T.L OF VILINJIAMBakkam TANK AS (+24.390M)
 THE BED LEVEL OF THE CULVERTS SHOULD BE FIXED IN PRESENCE OF THE EXECUTIVE ENGINEER CONCERNED ONLY AFTER THE EXISTING CHANNEL ORIGINAL BED LEVEL ASCERTAINED AND RESTORED FOR FLOW FROM NORTH TO SOUTH DIRECTION.

S. Channel No	S. F. No	Access to S.F. No	Proposed Bed level in M (+)	MFL in M (+)	Minimum inner Vent height in M or bottom level of deck slab	Width of Culvert in M	Area of culvert in SQ.M	No of vents allowed
1	637A or 52 @ LS 377m	625P or 50	22.010	24.050	6.90	7.20	48.68	1 No.
2	715 or 46 @ LS 413m	75 or 53	21.985	24.050	4.80	7.50	36.00	1 No.
3	715 or 46 @ LS 452m	75 or 43	21.960	24.050	5.90	9.15	53.99	1 No.
Total								139.67

- THE APPLICANT SHOULD DO PROPER SOIL TEST, AND SUITABLE FOUNDATION SHOULD BE SELECTED DEPENDING UPON THE SOIL CONDITION AND THE STRUCTURAL DESIGN SHOULD BE OBTAINED FROM THE APPROVED STRUCTURAL ENGINEER.
- THE PWD/WRD, WILL NOT BE HELD RESPONSIBLE FOR THE STRUCTURAL STABILITY, SAFETY AND SOUNDNESS OF THE BUILDING PROPOSED BY THEM AND PWD/WRD SPECIFICALLY RECOMMEND ONLY FOR CONSTRUCTION OF CULVERTS & INUNDATION POINT OF VIEW. THE APPLICANT SHOULD CONSTRUCT THE PROPOSED RCC BOX CULVERT-3NOS AT THEIR OWN COST. THEY ARE SOLELY RESPONSIBLE FOR THE STRUCTURAL SAFETY AND STABILITY OF THE PROPOSED CULVERT, AT ANY COST AND PWD/WRD WILL NOT BE HELD RESPONSIBLE FOR DESIGN AND DRAWING ADOPTED FOR PROPOSED CONSTRUCTION OF RCC BOX CULVERT.
- BASED ON THE HYDRAULIC PARTICULARS MENTIONED ABOVE, THE DESIGN AND DRAWINGS OF THE PROPOSED RCC BOX TYPE CULVERTS SHOULD BE OBTAINED FROM THE QUALIFIED STRUCTURAL DESIGN ENGINEER AND THE SAME SHOULD BE SUBMITTED TO THE EXECUTIVE ENGINEER, PWD, WRD, KOSASTHALAIYAR BASIN DIVISION, THIRUVALLUR FOR GETTING APPROVAL BEFORE THE COMMENCEMENT OF WORK. THE WORK SCHEDULE FOR ABOVE PROPOSAL SHOULD BE INFORMED TO THE EXECUTIVE ENGINEER, PWD, WRD, KOSASTHALAIYAR BASIN DIVISION, THIRUVALLUR FOR MONITORING AND ALSO COMPLETION OF CULVERT SHOULD BE REPORTED TO THE EXECUTIVE ENGINEER.
- THE APPLICANT SHOULD PAY AN ANNUAL LEASE RENT OF RS.1.69,000/- (RUPEES ONE LAKH SIXTY NINE THOUSAND ONLY) FOR OCCUPATION OF 139.67 SQ.M IN THE SHAPE OF DEMAND DRAFT DRAWN IN FAVOUR OF THE EXECUTIVE ENGINEER, PWD, WRD, KOSASTHALAIYAR BASIN DIVISION, THIRUVALLUR AND IT SHOULD BE PAID AT ONE LUMP SUM FOR THREE YEARS OF RS.5,07,000/- (RUPEES FIVE LAKH AND SEVEN THOUSAND ONLY) IN ADVANCE BEFORE THE COMMENCEMENT OF WORK. DURING EXECUTION/ AFTER CONSTRUCTION OF ABOVE CULVERTS IF ANY DEVIATIONS ARE NOTED IN ABOVE MEASUREMENTS ACCORDINGLY THE LEASE RENT ALSO ARE REVISED RESPECTIVELY.
- THE APPLICANT HAS TO PAY SERVICE TAX SEPARATELY AS PER NORMS IN EXISTENCE AND AS AMENDED FROM TIME TO TIME WITHOUT FAIL.
- THE APPLICANT SHOULD EXECUTE THE LEASE AGREEMENT WITH THE EXECUTIVE ENGINEER, PWD, WRD, KOSASTHALAIYAR BASIN DIVISION, THIRUVALLUR BEFORE COMMENCING THE WORK AND IT SHOULD BE RENEWED ONCE IN THREE YEARS FOR WHICH THE APPLICANT VOLUNTARILY HAS TO APPLY WITHIN 2 MONTHS, BEFORE THE EXPIRY OF THE LEASE PERIOD. THE LEASE RENT IS SUBJECT TO REVISION FROM TIME TO TIME AS PER GUIDELINE VALUE / GOVERNMENT ORDERS.
- THE APPLICANT IS ALSO TO PAY THE CAUTION DEPOSIT OF SUM OF RS.5,00,000/- (RUPEES FIVE LAKH ONLY) IN FAVOUR OF THE EXECUTIVE ENGINEER, PWD, WRD, KOSASTHALAIYAR BASIN DIVISION, THIRUVALLUR, WHICH WILL BE REFUNDED ONLY AFTER COMPLETION OF SIX MONTHS ON THE CERTIFICATE FROM CONCERNED ASSISTANT EXECUTIVE ENGINEER OF THIS DEPARTMENT THAT THE CONSTRUCTION WORK (CULVERT AND FIELD CHANNEL RETAINING WALL) WAS COMPLETED WITHOUT ANY DAMAGE TO THE GOVERNMENT PROPERTY OR THE DAMAGE CAUSED DURING EXECUTION IF ANY WILL BE RECTIFIED FULLY BY THE APPLICANT. IF FAILED THE COST OF RESTORATION WORK WILL BE BORNE FROM THE CAUTION DEPOSIT.
- THE APPLICANT SHOULD NOT CLAIM ANY PRIVILEGE ON THE ABOVE LEASED PORTION OF THE LAND AND IF THE LEASED PORTION OF THE LAND REQUIRED FOR THE GOVERNMENT FOR THE BENEFIT OF SOME OTHER LARGE GENERAL PUBLIC SCHEMES THE APPLICANT SHOULD NOT OBJECT TO HANDOVER THE LAND TO THIS DEPARTMENT FOR WHICH APPLICANT IS NOT ENTITLED FOR ANY COMPENSATION. FURTHER, THE LEASED PORTION LAND TO BE HANDED OVER TO THIS DEPARTMENT AS IS IN CONDITION.
- THE ABOVE PROPOSED CULVERTS WILL BE THE GOVERNMENT PWD/WRD PROPERTY AFTER THE CONSTRUCTION. THE APPLICANT SHOULD NOT CLAIM ANY PRIVILEGE ON THE ABOVE LEASE PORTION OF GOVERNMENT LAND (CULVERT LAND, CULVERT, FIELD CHANNEL RETAINING WALL ABUTTING THE APPLICANT LAND) AND SHOULD ALLOW THE WRD OFFICIALS TO INSPECT THE CHANNEL AS AND WHEN REQUIRED AND FOR THE PERIODICAL INSPECTION.
- IN CASE OF TRANSFER OF THE ABOVE SAID LANDS TO THE THIRD PARTY/ ASSOCIATION IN FUTURE, IN SUCH CASE THE LEASE RENT SHOULD BE PAID BY THE THIRD PARTY/ ASSOCIATION PERIODICALLY WITHOUT FAIL. OTHERWISE THE NOC WILL BE REVOKED.
- THE PERMISSION GRANTED TO THE APPLICANT SHOULD NOT BE ALTERED/MODIFIED/CHANGED TO ANY OTHERS. BASED ON THE RECORDS SUBMITTED BY THE APPLICANTS THE PERMISSION IS GRANTED. IF ANY DOCUMENTS SEEM TO BE FAKEMANIPULATED/FABRICATED IN FUTURE THE ABOVE PERMISSION WILL BE CANCELLED WITHOUT ANY CORRESPONDENCE AND DEPOSITED AMOUNT FOR CAUTION DEPOSIT WILL NOT BE REFUNDED. HENCE, THE APPLICANT IS SOLELY RESPONSIBLE OF GENUINETY OF THE DOCUMENTS SUBMITTED.
- THE PROPOSED RCC BOX CULVERTS SHOULD BE MONITORED AND MAINTAINED BY THE APPLICANT AT THEIR OWN COST. THE WIDTH OF THE CHANNEL SHOULD BE MAINTAINED WITHOUT ENCROACHING AS PER REVENUE RECORDS AND SHOULD MAINTAIN THE HYDRAULIC PARAMETERS OF THE FIELD CHANNEL WITHOUT ANY CHANGE.
- THE GOVERNMENT FIELD CHANNEL STRETCH ABUTTING THE BOUNDARY AND CROSSING THE PROPOSED LAND WITHIN THE APPLICANTS LAND SHOULD BE MARKED AS PER FMB AND MONITORED AND MAINTAINED BY THE APPLICANT AT THEIR OWN COST. THE WIDTH OF THE CHANNEL SHOULD BE MAINTAINED WITHOUT ENCROACHMENT AS PER REVENUE RECORDS AND THE HYDRAULIC PARAMETERS OF THE FIELD CHANNEL SHOULD BE MAINTAINED. THE APPLICANT SHOULD PROVIDE NECESSARY PERIODICAL ARRANGEMENTS FOR FREE FLOW OF WATER THROUGH THE EXISTING CHANNEL TO THE DOWNSIDE AREA WITHIN THE PROPOSED LAYOUT SITE. ALSO THE APPLICANT SHOULD DE-SILT THE CHANNEL PERIODICALLY AND REMOVE THE OBSTRUCTION THEN AND THERE WITHOUT ANY HINDRANCE FOR FREE FLOW OF WATER AT THEIR OWN COST WITHIN THE PROPOSED LAND, AFTER THE COMPLETION OF CULVERT.
- THE CONSTRUCTION OF ABUTMENT, WING WALL, RETURN WALL, ETC., SHOULD BE CONSTRUCTED WELL WITHIN THE APPLICANTS LAND ON EITHER SIDE. MOREOVER THE WIDTH OF FIELD CHANNEL AS PER REVENUE RECORDS (FMB) SHOULD BE MAINTAINED PROPERLY WITHOUT ANY CHANGE AT ANY COST.
- THE APPLICANTS LAND SHOULD BE FILLED WITH EARTH PROPER COMPACTION TO THE LEVEL OF (+)24.650M TO PROTECT THE SITE FROM INUNDATION DURING FLOODS. THE PROCESS OF EARTH FILLING AND COMPACTION SHOULD BE DONE FOR A DEPTH VARYING FROM 1.00M TO 1.28M DEPENDING UPON THE EXISTING FIELD LEVELS IN LAYERS OF NOT MORE THAN 0.30METER DEPTH TO ACHIEVE REQUIRED DEGREE OF COMPACTION AND THE EXISTING APPLICANT LAND SHOULD BE RAISED TO A LEVEL OF (+)24.650M AND (+)0.980M ABOVE THE EXISTING ROAD ABUTTING THE SITE AS (+)23.790M.
- THE APPLICANT SHOULD PROVIDE RAIN WATER HARVESTING ARRANGEMENTS IN THE SITE AT THEIR OWN COST.
- THE APPLICANT SHOULD MAKE NECESSARY ARRANGEMENTS FOR THE SEWERAGE TREATMENT AND FOR ITS DISPOSAL NECESSARY SUITABLE ARRANGEMENTS SHOULD BE MADE BY THE APPLICANT AT THEIR OWN COST WITHIN THE PREMISES ONLY AFTER OBTAINING NECESSARY PERMISSION FROM THE CHENNAI METROPOLITAN WATER SUPPLY AND SEWERAGE BOARD AND AS PER THE NORMS IN EXISTENCE AND AS AMENDED FROM TIME TO TIME AND SHOULD NOT BE LET INTO THE NEARBY CHANNEL OR STORM WATER DRAIN.
- THE APPLICANT SHOULD PROVIDE A PUCCA CONCRETE BED IN THE CHANNEL AT THE PROPOSED CULVERT SITES WITHOUT FAIL.
- THE APPLICANT SHOULD NOT CARRY OUT ANY OTHER CROSS MASONRY STRUCTURES ACROSS THE CHANNEL WITHOUT PRIOR PERMISSION FROM PWD/WRD.
- THE APPLICANT SHOULD MAKE THEIR OWN ARRANGEMENTS TO COLLECT THE DEBRIS AND GARBAGES WITHIN THE PREMISES DURING THE CONSTRUCTION OF BUILDING AND THE SAME HAS TO BE DISPOSED OFF AS PER THE NORMS PRESCRIBED BY THE TAMIL NADU POLLUTION CONTROL BOARD AND OTHER DEPARTMENTS CONCERNED AND SHOULD NOT BE DUMPED IN THE NEARBY CHANNEL, PUBLIC PLACES ETC.
- THE ALL-ROUND PAVEMENT LEVEL WITHIN SITE SHOULD NOT BE LESS THAN AT (+)24.650M. THE APPLICANT SHOULD PROVIDE ALL-ROUND AND INTERIOR STORM WATER DRAINAGE NETWORK, SO THAT THE ULTIMATE DISPOSAL OF STORM WATER SHOULD BE DISCHARGED TO THE NEAREST NATURAL STORM WATER CHANNEL/DRAINS ABUTTING THE APPLICANTS SITE (CHANNEL T.S.F NO.637A & 715, OLD S.F.NO.75, 52 & 46) SHOULD BE COMPLETELY DESILTED AND RESECTIONED BY CONSTRUCTING RETAINING WALL ON EITHER SIDE OF THE CHANNEL AS PER THE FMB AT THEIR OWN COST. THE BED LEVEL OF THE ABOVE CHANNEL SHOULD BE ASCERTAINED AND RESORTED BEFORE COMMENCING THE DEVELOPMENT ACTIVITY IN PRESENCE OF THE EXECUTIVE ENGINEER. MOREOVER THE WIDTH OF ENTIRE FIELD CHANNEL AS PER REVENUE RECORDS (FMB) WITHIN THE APPLICANTS LAND SHOULD BE MAINTAINED PROPERLY WITHOUT ANY CHANGE AT ANY COST. ALSO THE APPLICANT SHOULD PROVIDE EMERGENCY PUMPING OPERATION FOR THE SEEPAGE WATER IF IT IS PROPOSED TO HAVE BASEMENT FLOOR.
- THE APPLICANT SHOULD CLEARLY DEMARCAT THE BOUNDARY OF THEIR LAND BEFORE THE COMMENCEMENT OF ANY DEVELOPMENTAL ACTIVITIES INCLUDING CONSTRUCTION OF CULVERT IN PRESENCE OF REVENUE AUTHORITIES AND PWD/WRD AUTHORITIES CONCERNED WITHOUT FAIL AND SHOULD NOT ENCROACH THE CHANNEL ABUTTING THE LAND.
- THE PWD/WRD OFFICERS SHOULD BE ALLOWED TO INSPECT THE SITE AT ANY TIME DURING EXECUTION AND THEREAFTER. ADVANCE INTIMATION SHOULD BE GIVEN TO THE PWD/WRD OFFICERS CONCERNED BEFORE COMMENCE OF WORK.
- THE APPLICANT SHOULD ABIDE BY THE RULES AND REGULATION OF THE PWD/WRD FROM TIME TO TIME.
- THE APPLICANT SHOULD PROVIDE A SETBACK DISTANCE OF ABOUT 1.50M ON BOTH SIDES OF THE CHANNEL IN S.F.NO. 637A & 715, OLD S.F.NO. 52 & 46 AND AS WELL AS IN APPLICANTS LAND SIDE IN S.F.NO.75.

(ii) DR RULE NO. 29 (8)

THE AREA EARMARKED FOR PUBLIC PURPOSE PLOTS I TO III (VIZ. POST AND TELEGRAPH OFFICE, POLICE STATION ETC.) WOULD REMAIN RESERVED FOR A SPECIFIC PERIOD OF ONE YEAR FROM THE DATE OF APPROVAL TO ENABLE THE GOVERNMENT DEPT. CONCERNED TO NEGOTIATE WITH THE OWNER AND ACQUIRE THE RESERVED LAND IF REQUIRED FOR THEM. THE COST OF THE PLOT SHOULD NOT BE MORE THAN GUIDE LINE VALUE. IF THE PROMOTER ADDS PROPORTIONATE DEVELOPMENT COST ON THE PRICE OF THE PUBLIC PURPOSE PLOT, THE SAME SHOULD BE APPROVED BY CMDA.

(iii) DR RULE NO. 29 (9)

THE OWNER OR DEVELOPER OR PROMOTER SHALL SELL THE EWS PLOTS ONLY FOR EWS PURPOSE. NO CONVERSION OR AMALGAMATION SHALL BE PERMISSIBLE IN THE CASE OF EWS PLOTS.

(iv) DR RULE NO. 29 (11)

THE COST OF LAYING IMPROVEMENTS TO THE SYSTEMS INRESPECT OF ROAD, WATER SUPPLY, SEWERAGE, DRAINAGE OR ELECTRIC POWER SUPPLY THAT MAY BE REQUIRED AS ASSESSED BY THE COMPETENT AUTHORITY, SHALL BE BORNE BY THE APPLICANT.

(v) LOCAL BODY SHOULD ENSURE COMPLIANCE OF ALL THE CONDITIONS STIPULATED BY PWD IN THEIR LETTER NO DB/75(3)/F-1&C-VILINJIAMBakkam/2018/13.06.2017, AND SHALL OBTAIN A LETTER FROM PWD CONFIRMING THE COMPLIANCE OF THE CONDITIONS BEFORE THE SANCTION AND RELEASE OF THE LAYOUT.

LEGEND:

- SITE BOUNDARY
- ROADS GIFTED TO THE LOCAL BODY
- EXISTING ROAD
- PARK GIFTED TO THE LOCAL BODY
- PUBLIC PURPOSE
- E.W.S
- CHANNEL
- SHOP SITE
- NO DEVELOPMENT AREA

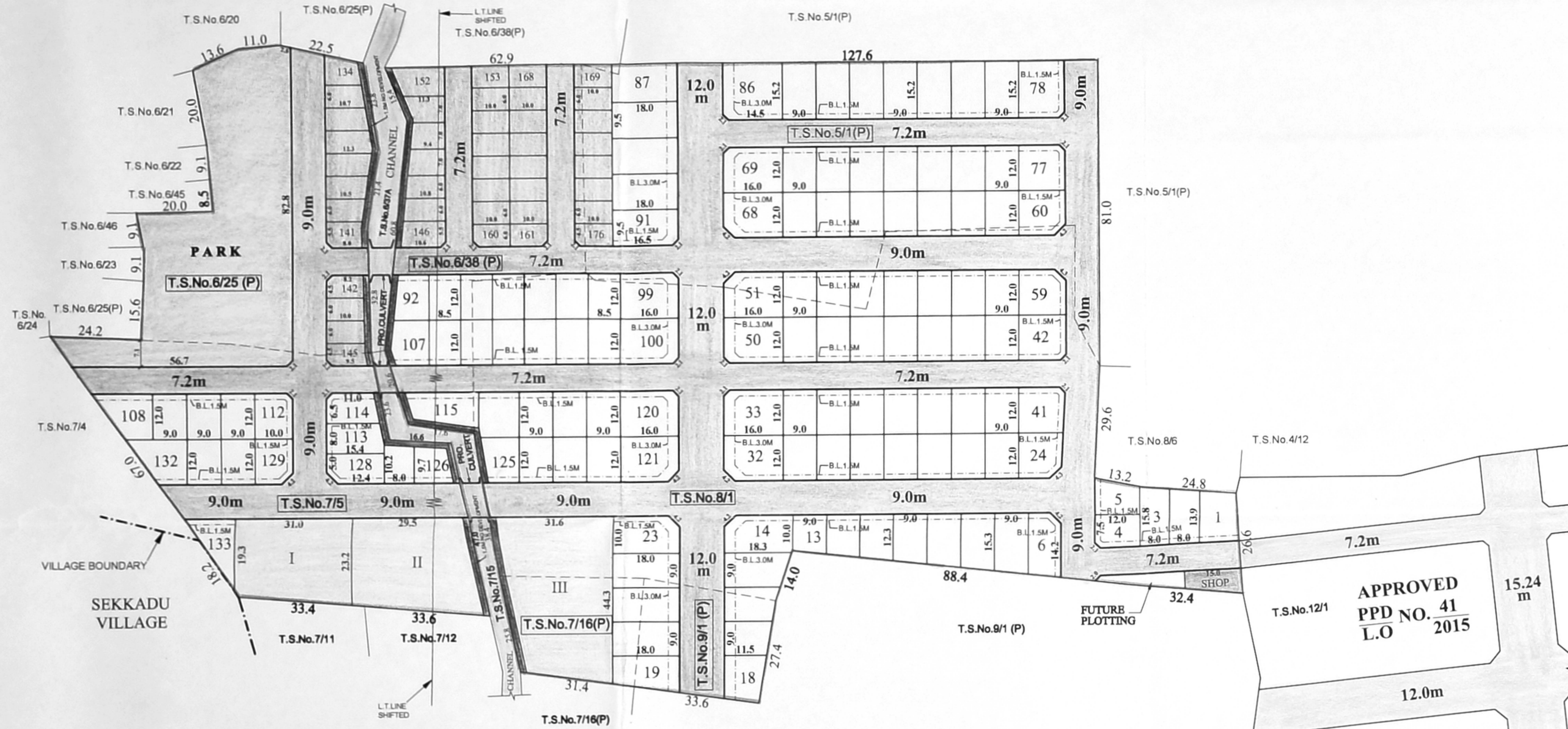

**APPROVED
 PPD NO. 41
 L.O NO. 2015**

PREPARED BY P.A-IV (S.M) [Signature] 29/04/18
 CHECKED BY P.A.II (A.A) [Signature] 29/04/2018
 A.P.(S.A) [Signature] 29/04/2018

AVADI MUNICIPALITY

THE LAYOUT OF HOUSE SITES IN T.S.Nos: 5/1pt, 6/25pt,38pt, 7/5,16pt, 8/1, 9/1pt, WARD-G, BLOCK No:21 (OLD S.Nos: 35/3, 42/1A,1B,2A,2B, 43/1,2, 44/1pt, 45/2pt, 48/1,2,3,4,5A,5B, 49, 50, 51/4,5,6,7,8,9,10,11,12, 53/1,2,3,4Apt,4B,5pt, 54/1pt,2,3, 55, 56/1,2pt,3pt, 57/1pt, 66/4pt) OF VILINJIYAMBakkam VILLAGE.

SCALE : 1:800 (ALL MEASUREMENTS ARE IN METRE.)

CONDITIONS:
 THE LAYOUT APPROVED IS VALID SUBJECT TO OBTAINING SANCTION FROM THE LOCAL BODY CONCERNED.

P.P.D NO : 16
L.O NO : 2018

APPROVED
 VIDE LETTER NO : L1/6916/2016
 DATE : 28 /02/2018

[Signature]
 FOR MEMBER SECRETARY
 CHENNAI METROPOLITAN
 DEVELOPMENT AUTHORITY

